

	dimensioni l / a / q	BRECO no. art.	descrizione	CAP - 13
 	180 / 52 / 3	26186	① coperchio in alluminio estruso o in acciaio, 4 mm senza protezione, vedi dettaglio c	
	240 / 52 / 3	26246		
	300 / 52 / 3	26306		
	360 / 52 / 3	26366		
	180 / 65 / 3	26187	② profilo neoprene ③ base in acciaio, 2 mm, combinata con profili in alluminio estruso con protezione, vedi dettaglio c dispositivo di livellamento coperchio di legno provvisorio - q = quantità delle camere	
	240 / 65 / 3	26247		
	300 / 65 / 3	26307		
	360 / 65 / 3	26367		

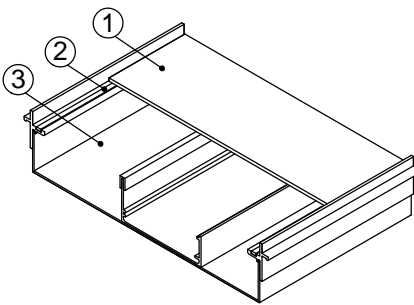

dettaglio c

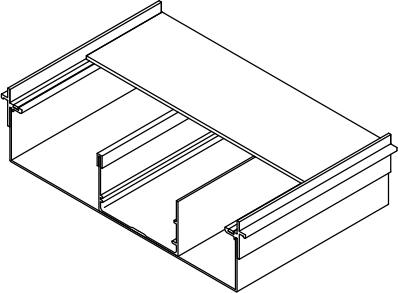
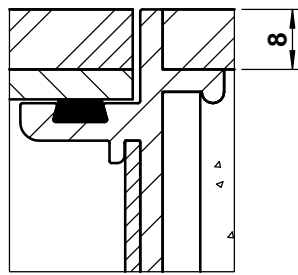
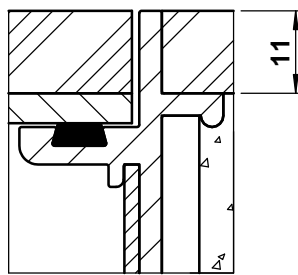

dettaglio c

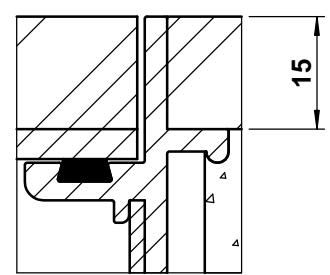

dettaglio c

